

<b>Detalles de Cubierta</b>		06/17
Canal exterior		SE
 <b>ACH</b> A Saint-Gobain brand		03

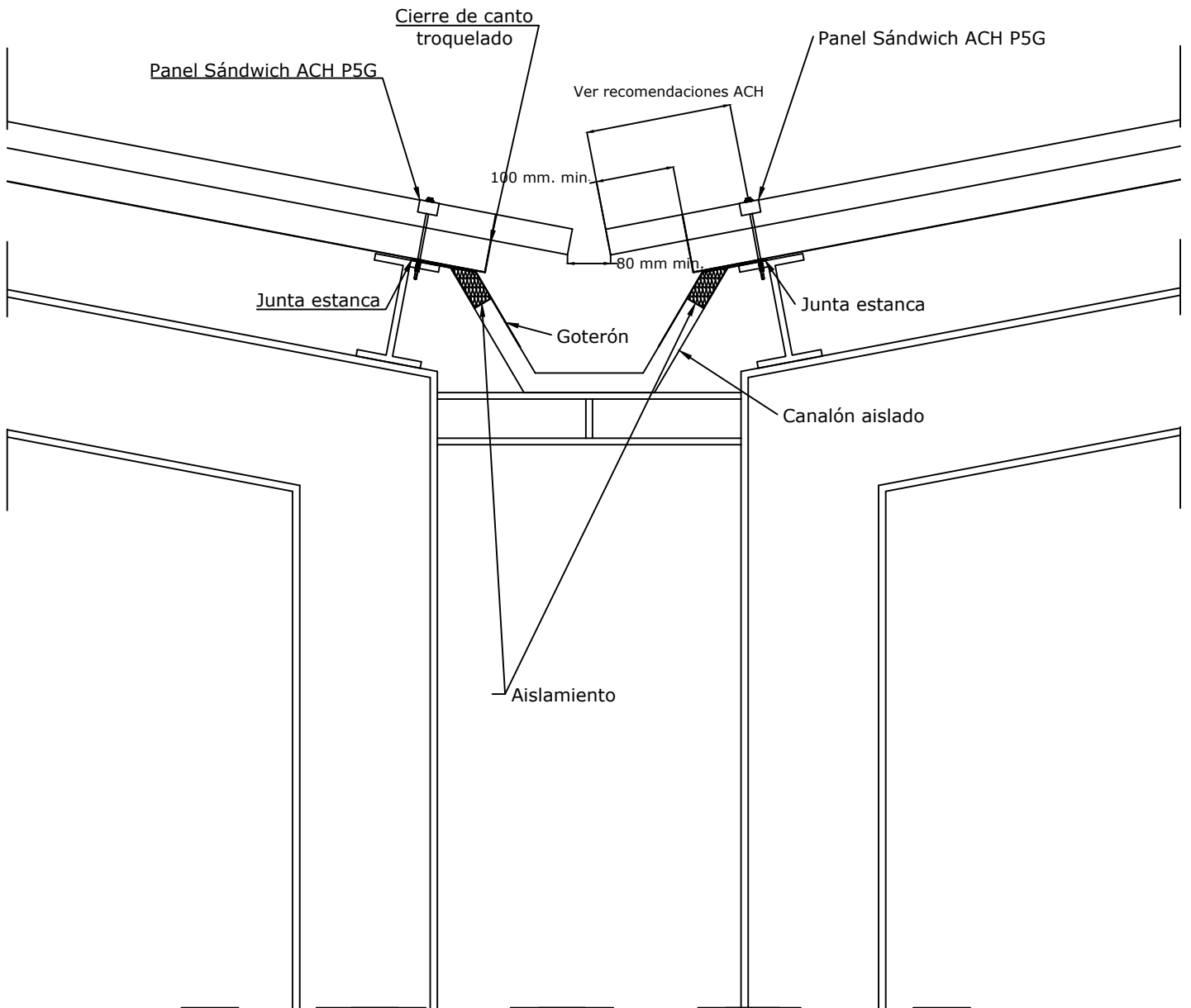

<b>Detalles de Cubierta</b>		06/17
Canal central aislado		SE
<b>ACH</b> A Saint-Gobain brand		02

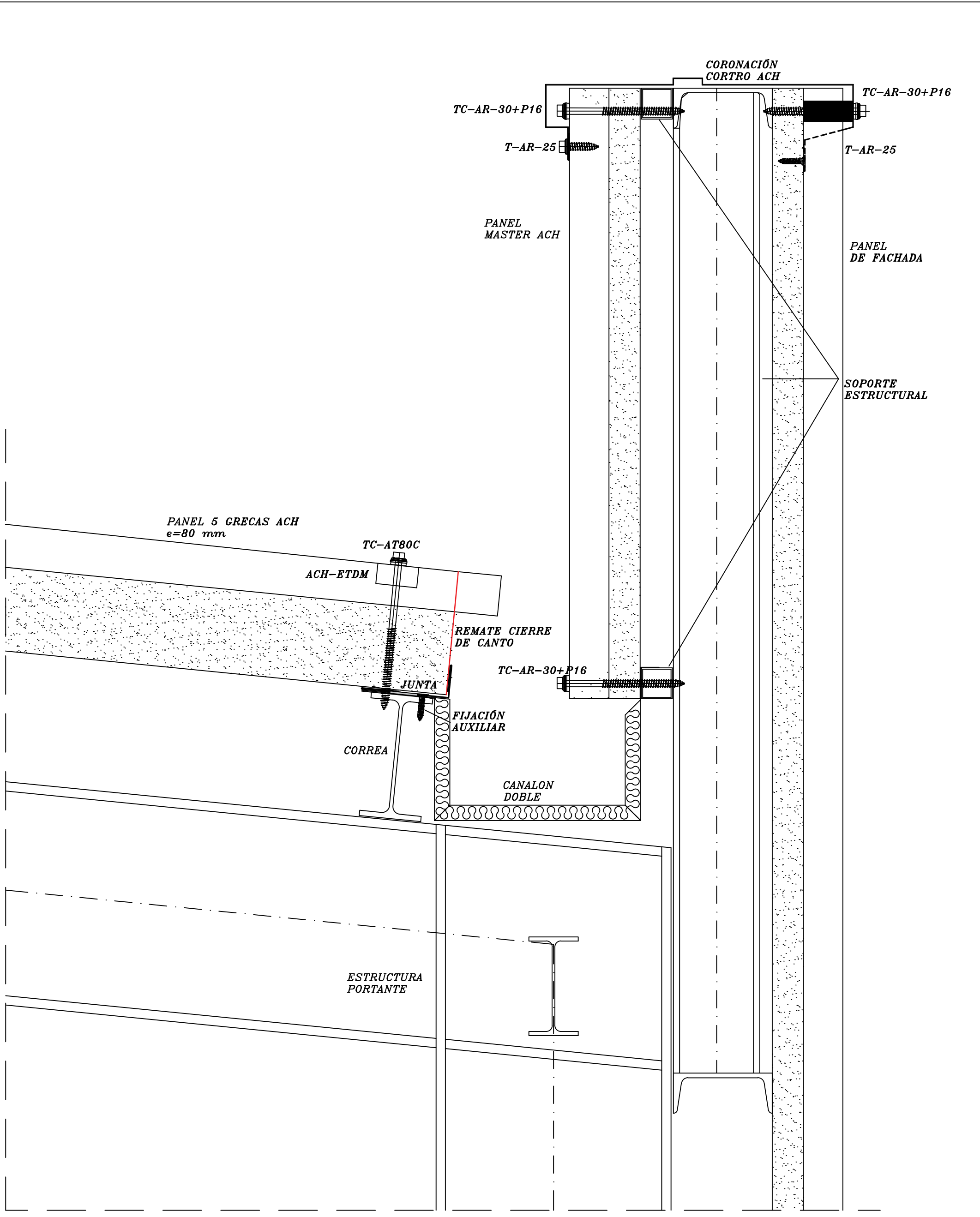

<b>Detalles de Cubierta</b>		06/17
Canalón con peto		SE
		04

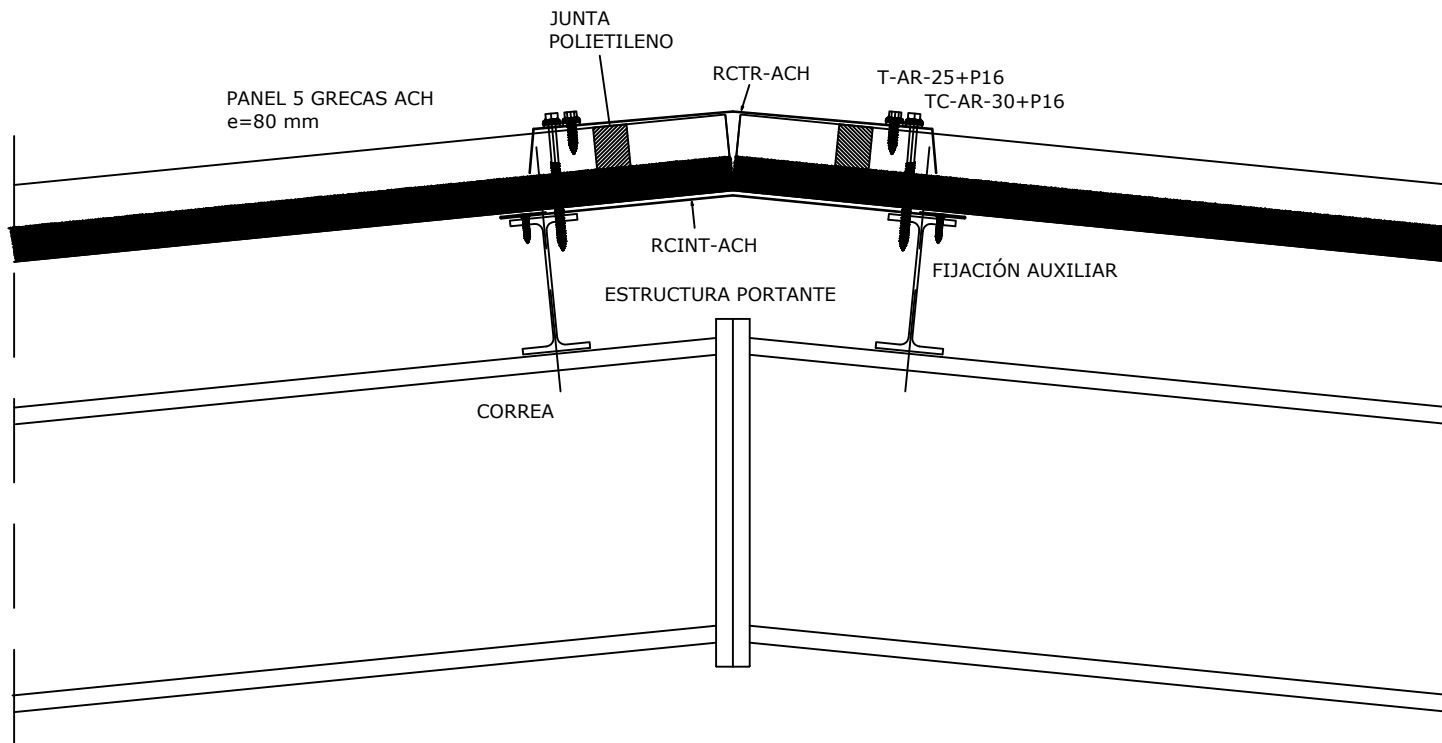

<b>Detalles de Cubierta</b>		06/17
Cumbrera P5G		SE
 <span style="font-size: small;">A Saint-Gobain brand</span>		08

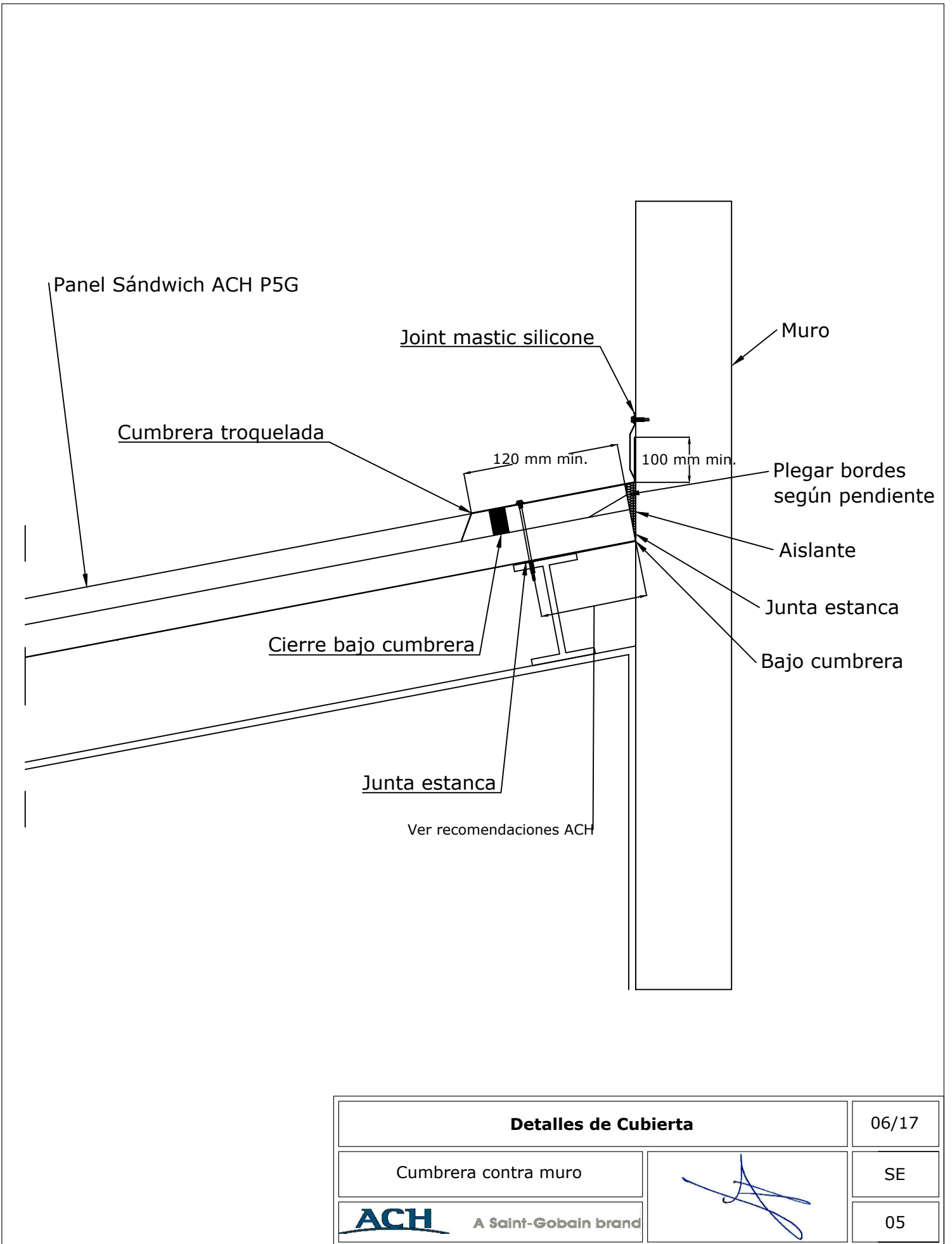

<b>Detalles de Cubierta</b>		06/17
Cumbrera contra muro		SE
 <b>ACH</b> A Saint-Gobain brand		05

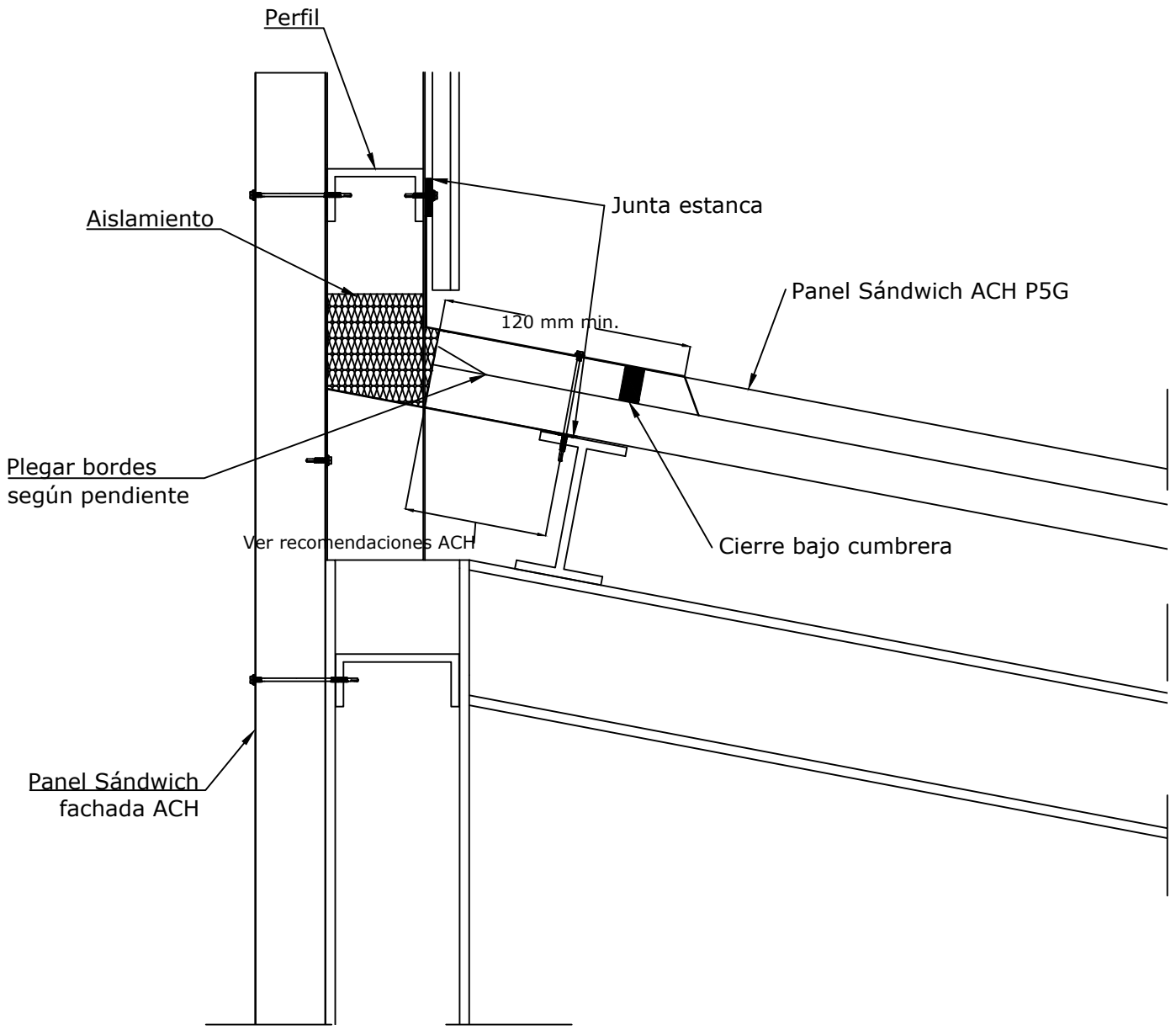

<b>Detalles de Cubierta</b>		06/17
Cumbrera contra peto		SE
		06

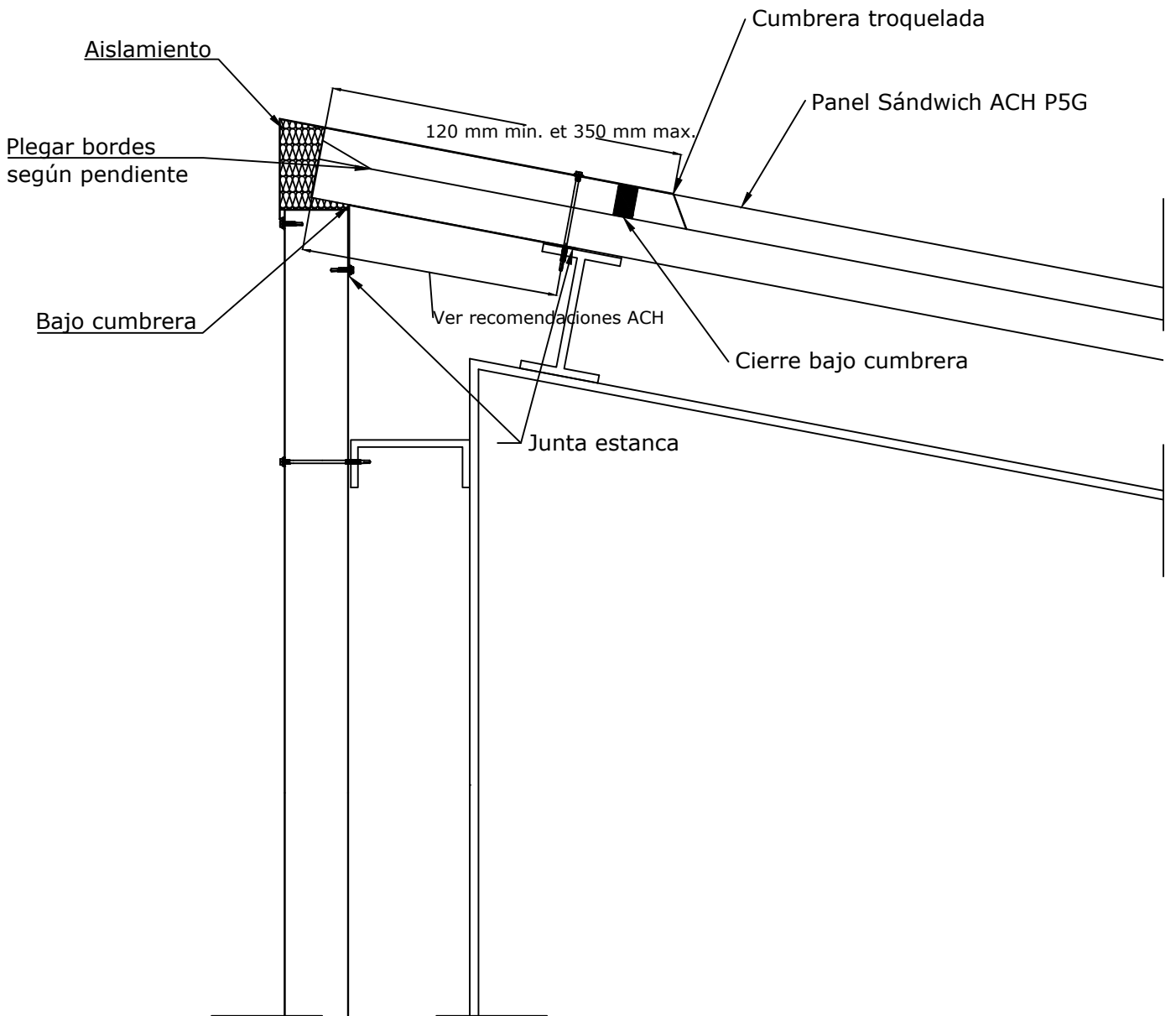

<b>Detalles de Cubierta</b>		06/17
Cumbrera simple		SE
 <b>ACH</b> A Saint-Gobain brand		07

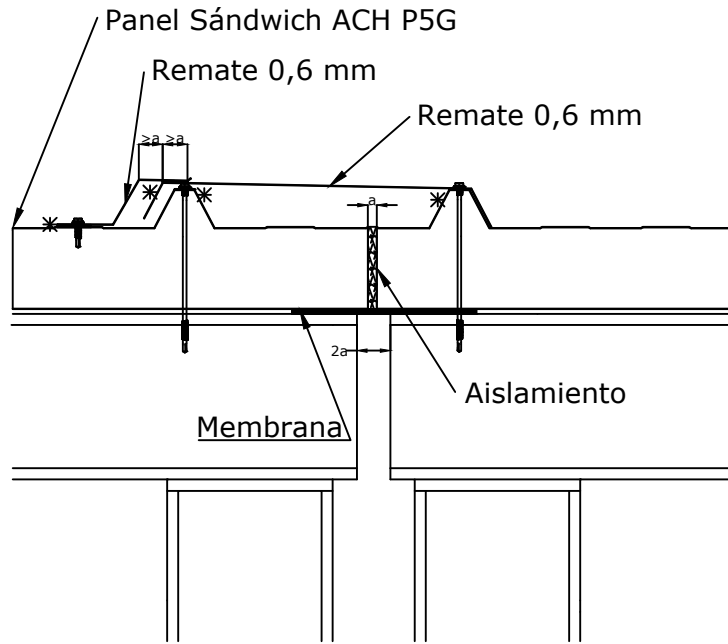

\* Junta de estanqueidad  
Espacio entre grecas máximo 400 mm

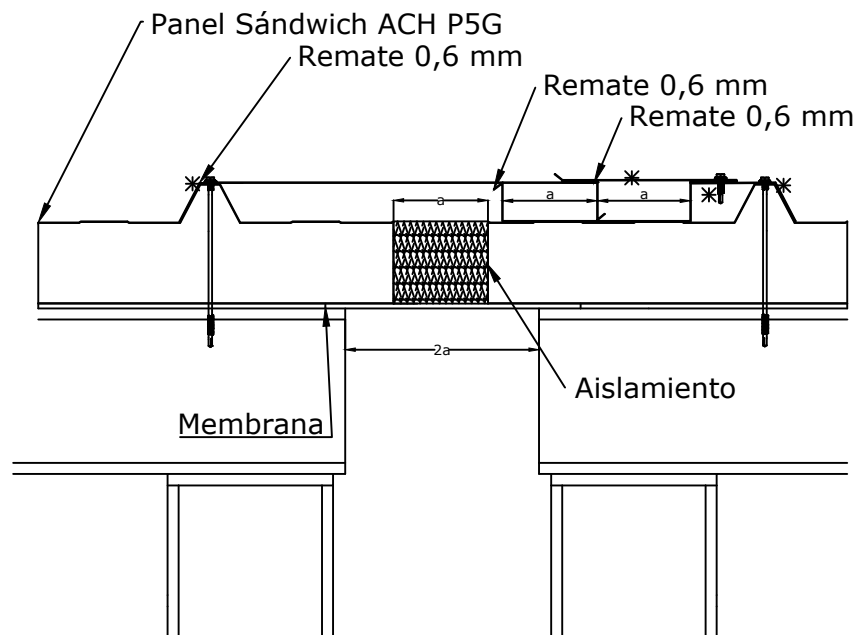

\* Junta de estanqueidad  
Espacio entre grecas mayor de 400 mm

<b>Detalles de Cubierta</b>		06/17
Juntas de dilatación		SE
 <b>ACH</b> A Saint-Gobain brand		09



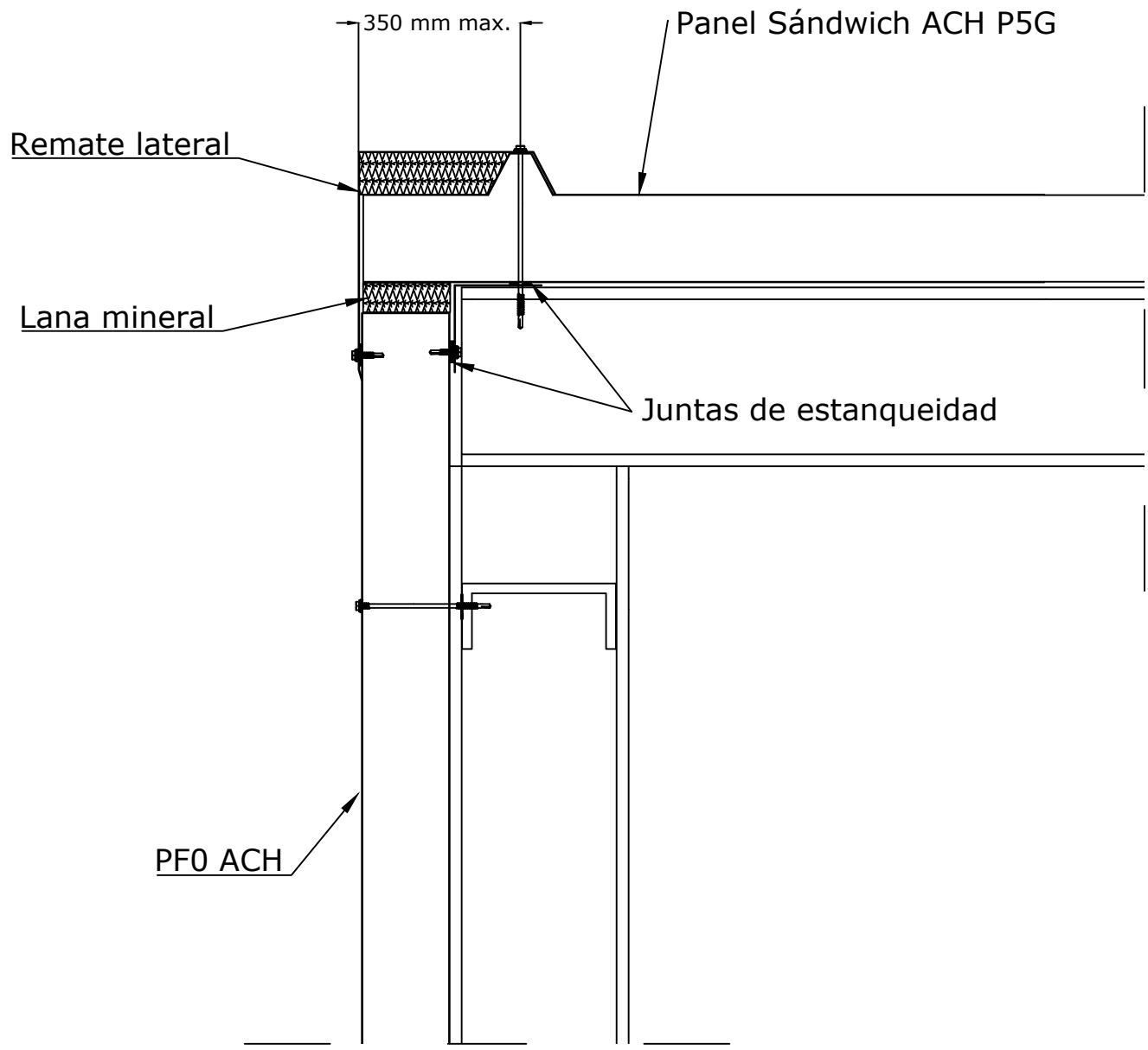

<b>Detalles de Cubierta</b>		06/17
Muro piñón		SE
 <b>ACH</b> A Saint-Gobain brand		11

Coronación

350 mm max.

Remate lateral

Panel ACH P5G

Aislamiento

Remate rincón

Junta estanca

Panel Sándwich de fachada ACH

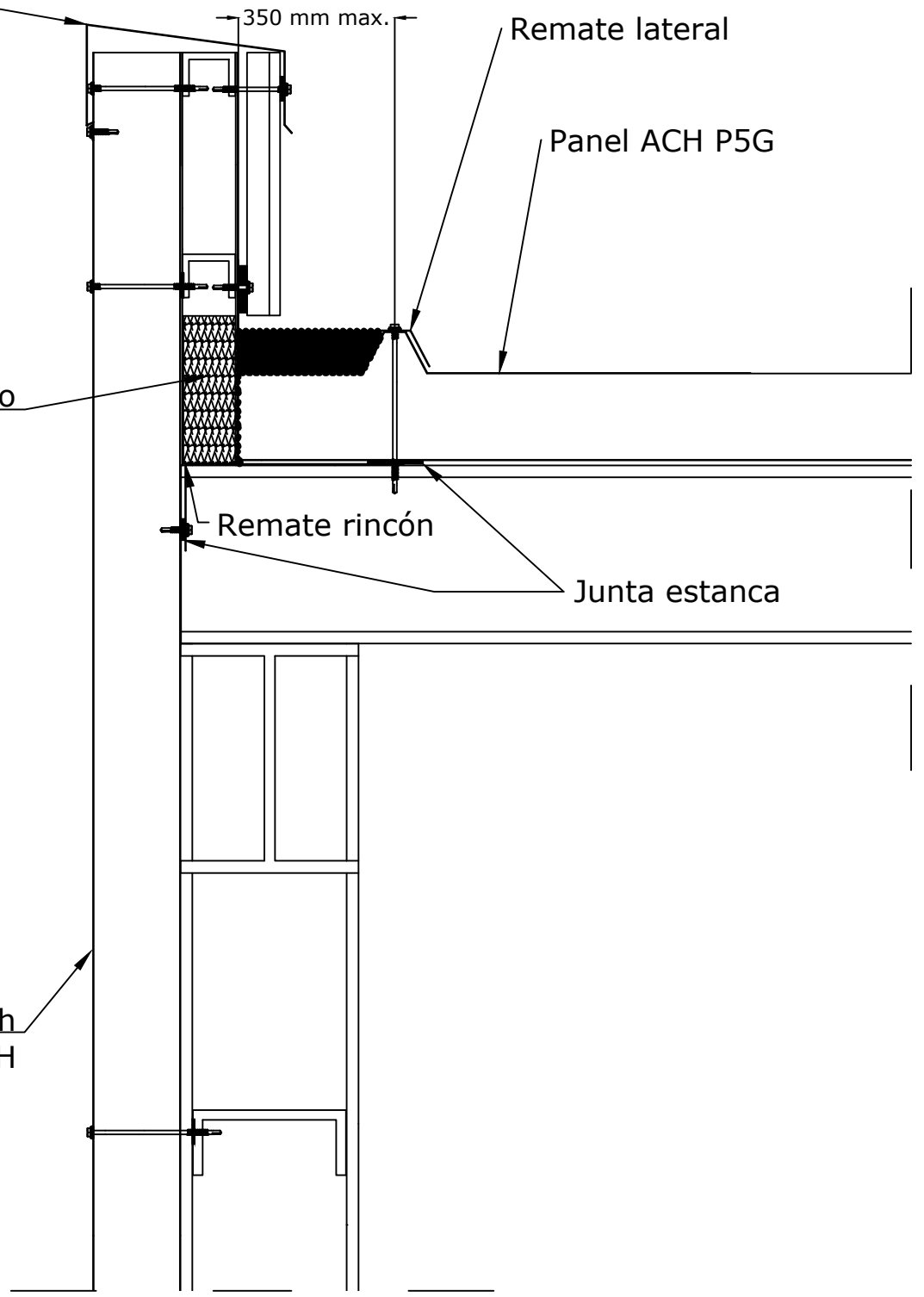

<b>Detalles de Cubierta</b>		06/17
Muro piñón con peto		SE
<span style="font-size: small;">A Saint-Gobain brand</span>		10

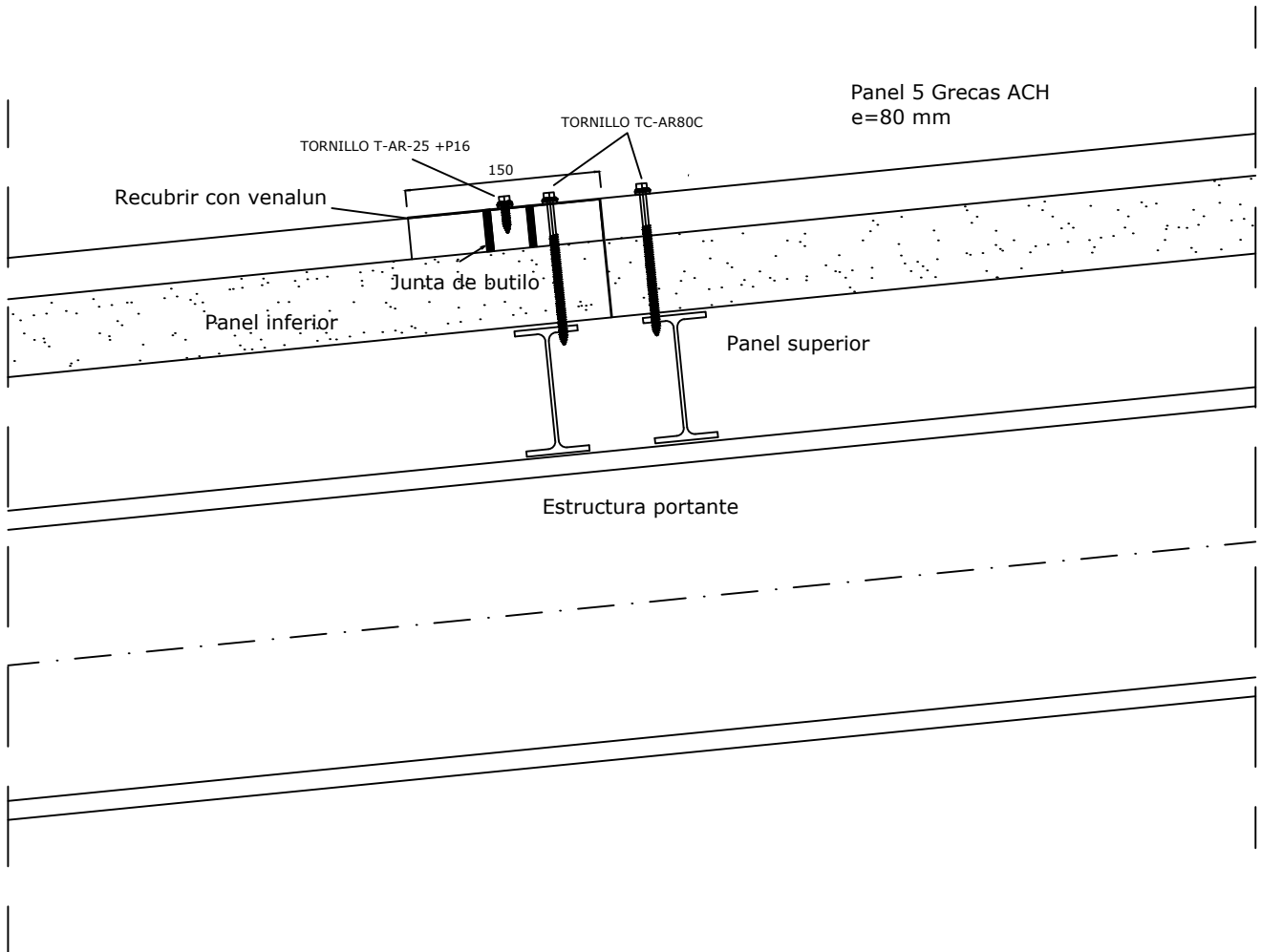

<b>Detalles de Cubierta</b>		06/17
Solape-Cubierta P5G 80		SE
 <b>ACH</b> A Saint-Gobain brand		12

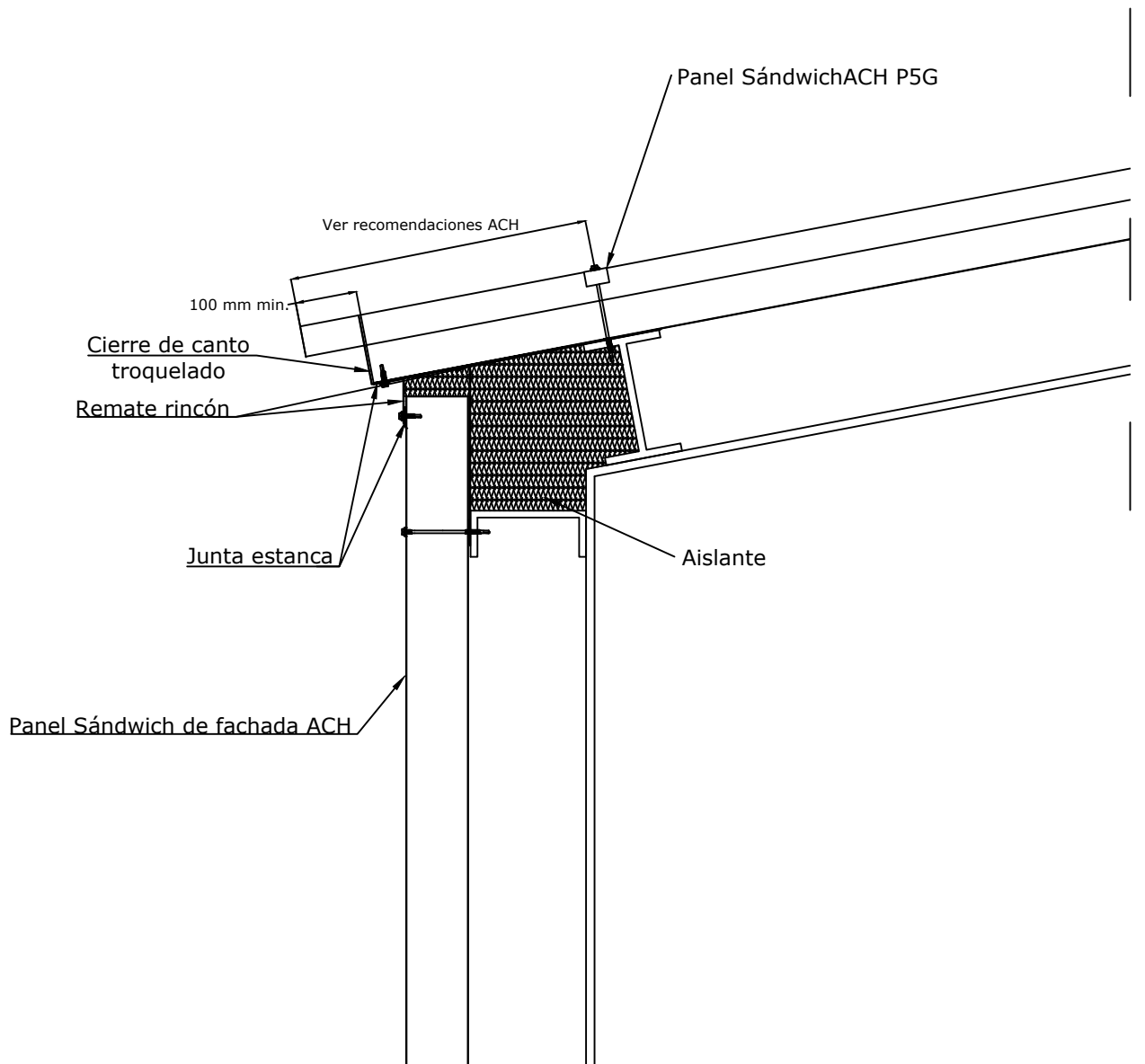

<b>Detalles de Cubierta</b>		06/17
Vertido sin canal		SE
 <b>ACH</b> A Saint-Gobain brand		13